

SAMSUNG



HEADSET Quick Start Guide WEP301

MOBILE ENHANCEMENT

■ **Headquarters:**
1301 East Lookout Drive Richardson,
TX 75082

■ **Internet Address:**
[http://www.samsungmobileusa.com/
accessories](http://www.samsungmobileusa.com/accessories)

■ **Customer Care Center:**
1-888-987-4357

Guide No.: GH68-18612A
04/2008. Rev. 1.0

Checking the accessories

Make sure you have the following items with your headset : Travel Adapter, User's Guide,
3 Earpiece Covers(Large, Medium, Small)

- NOTE:**
The items supplied with your headset may vary depending on your region.

Charging the headset

Put the adapter into the jack on the headset and into the electrical outlet. Charge the headset until the red indicator light turns blue.



- NOTE:**
- Do not attempt to charge the headset with anything other than the adapter provided.
 - You can use your headset while charging.

Your headset overview

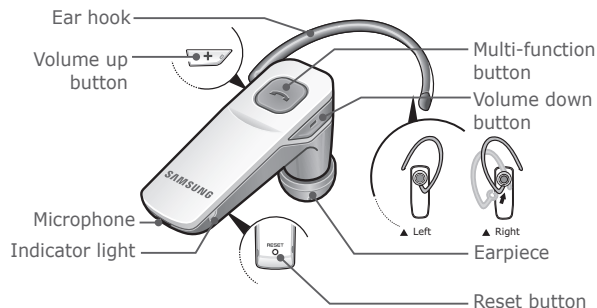

- NOTE:**
Depending on which ear you will wear the headset, simply adjust the ear hook accordingly.

Turning the headset on or off

To turn the headset on, press and hold the Multi-function button until the blue indicator light flashes 4 times. To turn the headset off, press and hold the Multi-function button until both blue and red indicator lights flash.

Understanding various modes

- **Standby mode:** The headset is waiting for a call. The blue indicator light flashes every 3 seconds.
- **Active mode:** The headset has a call in progress. The blue indicator light flashes every 8 seconds.
- **Pairing mode:** The blue indicator light stays lit. You can discover and connect to your headset on your phone.
- **Low battery mode:** There is less than 10% of battery power left. The red indicator light flashes. You must recharge the battery.

Pairing with your Bluetooth phone

- 1 Enter Pairing mode.
 - Turn off your headset and press and hold the Multi-function button until the blue indicator light remains lit after blinking.
 - If you turn it on for the first time, it proceeds into Pairing mode immediately.
- 2 Search for and pair with your phone according to your phone's user guide. (Bluetooth PIN: 0000, 4 zeros)
 - If the pairing is successful, the blue indicator light will flash 10 times rapidly before entering Standby mode.
 - If the blue indicator light remains lit, retry pairing.

NOTE:

When the headset and the phone are paired, the headset attempts to reconnect automatically each time it turns on. Otherwise, press the Multi-function button to reconnect.

Using call functions

Some features may not be supported by your phone.

In Standby mode

Press the Multi-function button to:

- Answer an incoming call
- Redial the last number called

Press and hold the Multi-function button to:

- Make a voice-activated call
- Reject an incoming call

Press and hold [+] and [-] at the same time to turn the indicator light on or off.

In Active mode

Press the Multi-function button to:

- End a call
- Transfer a call from the phone to the headset

Press and hold the Multi-function button to:

- Place a call on hold
- Answer a second call
- Retrieve a call on hold

Press [+] or [-] to adjust the volume.

Press and hold [+] or [-] to turn the microphone off or on.

Specifications

Item	Specifications and description
Bluetooth version	Compatible with Bluetooth 2.0 or earlier
Support profile	Headset Profile, Hands-Free Profile
Operating range	Up to 30 feet (10 meters)
Standby time	Up to 80 hours*
Talk time	Up to 5 hours*

* Depending on the phone type and usage, the actual time may vary.